

Transfer Procedures: International to Domestic

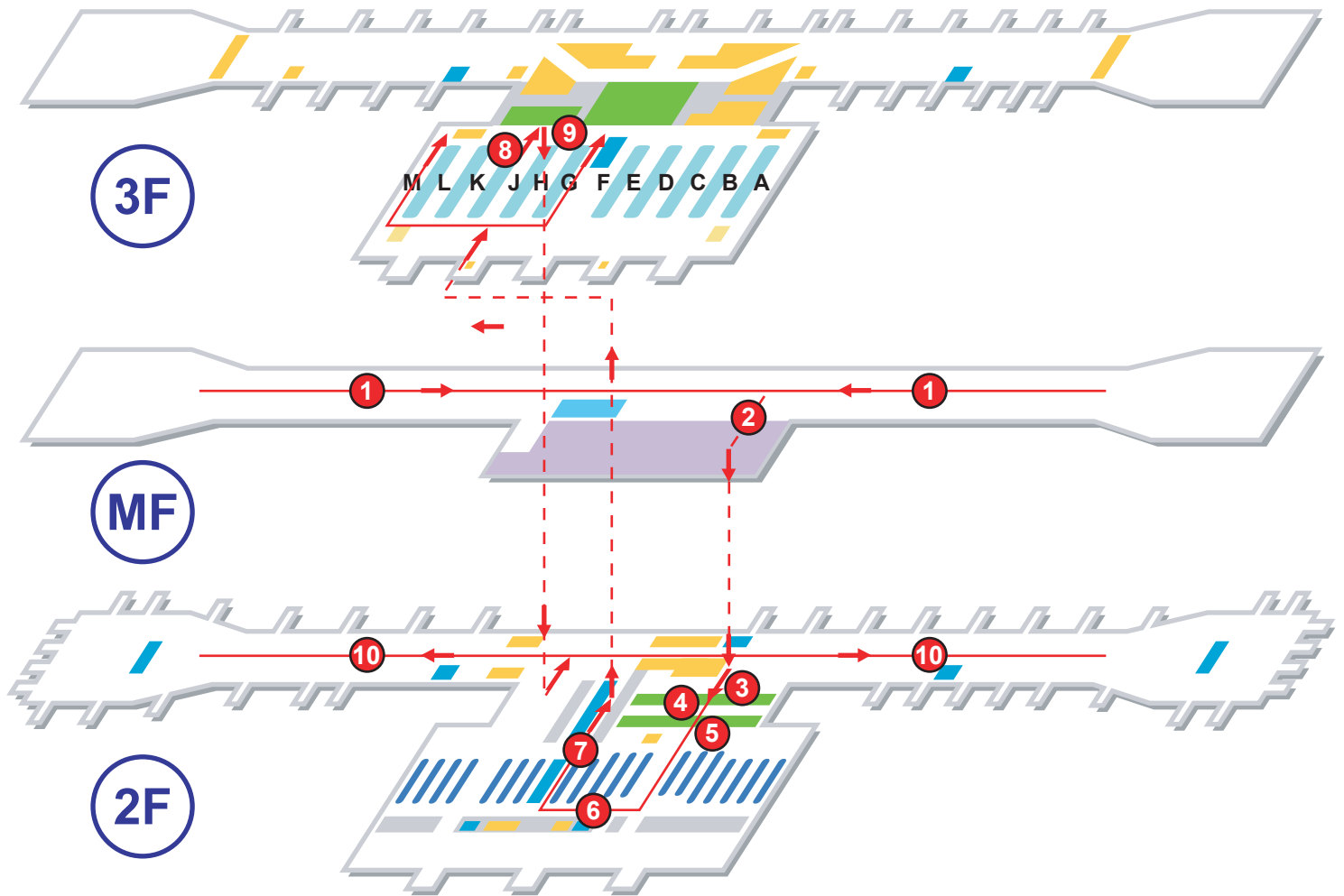

- ticketing
- customs and security check
- commercial area
- VIP waiting room
- baggage claim
- no entry
- transit hall
- no entry

- 1 enter the terminal by boarding bridge or ferry cars
- 2 arrive at the corridor
- 3 quarantine check
- 4 immigration (fill in the exit card)
- 5 customs inspection and declaration
- 6 baggage claim
- 7 transit and ticketing
- 8 security check
- 9 check in baggage
- 10 wait at the concourse
- 11 boarding